

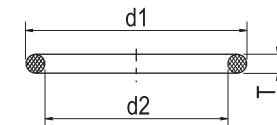

STAINLESS STEEL
150 LBS SCREWED FITTINGS
BSPP (ISO 228-1), BSPT (ISO 7-1), NPT THREAD
 MATERIAL CONFORM TO ASTM A351 GR. CF8 & CF8M
 PRESSURE-TEMPERATURE RATINGS 300 PSI (-29 TO 66°C)
 MADE BY LOST WAX INVESTMENT CASTING

TANK SKIN FITTING

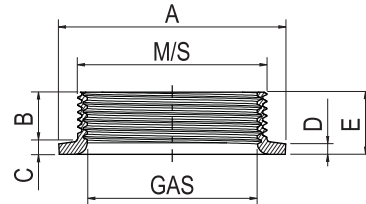
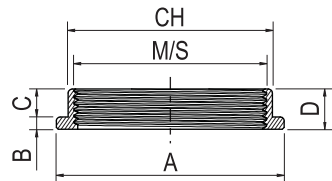
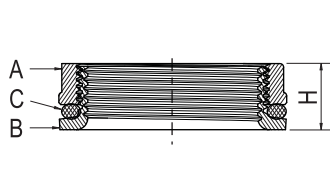
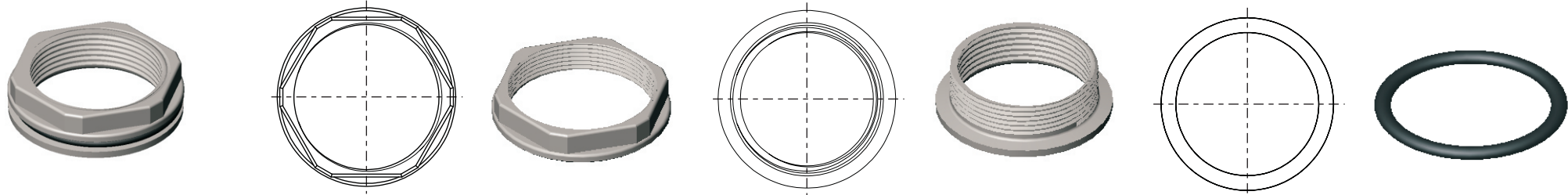

PART "A"

PART "B"

PART "C"

DIMENSIONS

Size	Total H (mm)
1"	17.5
1½"	17.5
2"	20.5

DIMENSIONS PART "A"

A (mm)	B (mm)	C (mm)	D (mm)	M / S (mm)	CH (mm)	
45.5	2.9	6.6	9.5	34.0	1.5	39.5
60.5	3.7	7.3	11.0	50.0	1.5	54.0
77.2	3.5	9.9	13.4	62.0	1.5	67.0

DIMENSIONS PART "B"

A (mm)	B (mm)	C (mm)	D (mm)	E (mm)	GAS	M / S (mm)	
44.9	11.9	4.0	2.6	15.9	1"	34.0	1.5
60.0	13.1	3.3	2.7	16.4	1½"	50.0	1.5
74.0	13.5	4.0	2.5	17.5	2"	62.0	1.5

DIMENSIONS PART "C"

d1 (mm)	d2 (mm)	T (mm)	Weight (Kg/Pc)
45.0	35.0	5.0	0.06
58.5	50.5	4.0	0.09
72.5	62.5	5.0	0.17